

# 2 PUBLIC AUCTIONS

**EXCELLENT WELL MAINTAINED LATE MODEL FARM EQUIPMENT**

## AUCTION #1

**ONLINE ONLY LIVE WEBCAST**  
(No Onsite Bidding)



**FEATURING:** (3) 2006 Schramm T-130XD & TM-130XD Well Drilling Rigs, 2012 Schramm 130XD Loadsafe, (23) 2014 Valley Sprinklers 8000 Series Center Irrigation Pivots, 2012 Komatsu HB215LC-1 Hybrid Excavator, 2009 Ford F550XL Service Truck, 2000 Freightliner FL80 Fuel Truck

**WEBCAST AUCTION STARTS:**

**TUESDAY, JANUARY 24<sup>TH</sup> @ 11AM PST (2PM EST)**

**PREVIEW & INSPECTION:** Jan. 19, 20 & 23, 9am-4pm by Appt.

**LOCATIONS:** 4536 W. Dora Drive, Golden Valley, AZ 86409

Mile Marker 32.5 Stockton Hill Road, Kingman, AZ 86409

8380 Nevada Highway 159, Blue Diamond, NV 89004

**2006**



**3 Available**

SCHRAMM T-130XD & TM-130XD WELL DRILLING RIGS

**2014**



**23 Available**

FULL VIEW OF IRRIGATION PIVOT

## AUCTION #2

**ONLINE ONLY LIVE WEBCAST**  
(No Onsite Bidding)

**Delta**  
AG Group, LLC

**FEATURING:** (5) 2008 John Deere 8330 tractors, (1) 2007 John Deere 6420 Tractor, (2) 2008 Great Plains 2700 Grain Drills, (1) 2002 John Deere 637 Disc, (1) 1998 John Deere 8300 Tractor, (1) John Deere 9750STS Combine, (1) 2007 John Deere 9860STS Combine

**WEBCAST AUCTION STARTS:**

**WEDNESDAY, JANUARY 25<sup>TH</sup> @ 11AM CST (12PM EST)**

**PREVIEW & INSPECTION:** Jan. 20, 23 & 24, 9am-4pm by Appt.

**LOCATION:** 4085 Highway 509, Mansfield, LA

**AS NEW AS**  
**2008**



**5 Available**

JOHN DEERE MODEL 8330 TRACTOR

**2007**



JOHN DEERE MODEL 9860STS COMBINE

**FOR FURTHER INFO. CONTACT:** Taso Sofikitis at (248) 569-9781 or email [taso@maynards.com](mailto:taso@maynards.com)

SALE CONDUCTED BY  
**Maynards**  
SINCE 1902

AUCTIONS | LIQUIDATIONS | APPRAISALS

21700 Northwestern Hwy.  
Suite 1180  
Southfield, MI 48075  
Tel: (248) 569-9781

[www.maynards.com](http://www.maynards.com)

IN CONJUNCTION WITH  
**BIDITUP**  
BIDITUP AUCTIONS WORLDWIDE  
AN INDUSTRIAL ASSETS COMPANY  
[www.biditup.com](http://www.biditup.com)

Place your bid now!  
REGISTER AT

**BidSpotter.com**



# AUCTION #1

**ONLINE ONLY LIVE WEBCAST** (No Onsite Bidding)



**WEBCAST AUCTION STARTS: TUES., JAN. 24<sup>TH</sup> @ 11AM PST (2PM EST)**

**PREVIEW & INSPECTION:** Jan. 19, 20 & 23, 9am-4pm by Appointment

**LOCATIONS:** 4536 W. Dora Drive, Golden Valley, AZ 86409

Mile Marker 32.5 Stockton Hill Road, Kingman, AZ 86409

8380 Nevada Highway 159, Blue Diamond, NV 89004

**2006**



**3 Available**

SCHRAMM T-130XD & TM-130XD WELL DRILLING RIGS



**EQUIPMENT LOCATED IN GOLDEN VALLEY FARM**  
4536 W. Dora Drive, Golden Valley, AZ

- (3) 2006 Schramm T-130XD & TM-130XD Well Drilling Rigs
- 2012 Schramm 130XD Loadsafe
- 2000 Freightliner FL80 Fuel Truck

**EQUIPMENT LOCATED IN RED LAKE FARM**  
Mile Marker 32.5 Stockton Hill Rd. Kingman, AZ

- (23) 2014 Valley Sprinklers 8000 Series Center Irrigation Pivots

**EQUIPMENT LOCATED IN**  
**BLUE DIAMOND HILL GYPSUM**  
8380 Nevada Highway 159 Blue Diamond, NV

- 2012 Komatsu HB215LC-1 Hybrid Excavator
- 2009 Ford F550XL Service Truck

**2012**



KOMATSU HB215LC-1 HYBRID EXCAVATOR

**2014**



**23 Available**

FULL VIEW OF IRRIGATION PIVOT

**2009**



FORD F550XL SERVICE TRUCK

**2000**



FREIGHTLINER FL80 FUEL TRUCK

**For further info. contact: Taso Sofikitis at (248) 569-9781 or email [taso@maynards.com](mailto:taso@maynards.com)**



# AUCTION #2

ONLINE ONLY LIVE WEBCAST (No Onsite Bidding)

**Delta**  
AG Group, LLC

WEBCAST AUCTION STARTS:  
**WEDNESDAY, JANUARY 25<sup>TH</sup> @ 11AM CST (12PM EST)**  
PREVIEW & INSPECTION: Jan. 20, 23 & 24, 9am-4pm by Appointment  
LOCATION: 4085 Highway 509, Mansfield, LA

AS NEW AS  
**2008**



**5 Available**

JOHN DEERE MODEL 8330 TRACTOR

- (5) John Deere Model 8330 Tractors, as New as 2008, as Low as 6,065.5 Hours, S/N RW8330P022531, RW8330P022554, RW8330P021953, RW8330P023130, RW8330P023004
- John Deere Model 8300 Tractor, New in 1998, S/N ROTD168043518
- John Deere Model 6420 Tractor, New in 2007, Approximately 4,500 Hours, S/N L0640H438868
- (2) Great Plains Model 2700 Grain Drills, New in 2008, 27', S/N P1742E, P1743E
- John Deere Model 637 Disc, 26'5", New in 2002, S/N 1823
- John Deere Model 9860STS Combine, with Hydruflex 630F, New in 2007, Estimated 3000 Hours, S/N H0980S720565
- John Deere Model 9750STS Combine, with Hydruflex 630F, New in 2003, Estimated 4000 Hours, S/N 691314

**2007**



JOHN DEERE MODEL 6420 TRACTOR

AS NEW AS  
**2008**



**5 Available**

JOHN DEERE MODEL 8330 TRACTOR

**2007**



JOHN DEERE MODEL 9860STS COMBINE

**2002**



JOHN DEERE MODEL 637 DISC

**2 Available**

AS NEW AS  
**2008**



GREAT PLAINS MODEL 2700 GRAIN DRILL



JOHN DEERE MODEL 630F COMBINE ATTACHMENT



# 2 PUBLIC AUCTIONS

## AUCTION #1

**ONLINE ONLY LIVE WEBCAST (No Onsite Bidding)**



**Kingman Farms**

WEBCAST AUCTION STARTS:

**TUES., JANUARY 24<sup>TH</sup>**  
**@ 11AM PST (2PM EST)**

**LOCATIONS:** Golden Valley, AZ  
 Kingman, AZ, Blue Diamond, NV



**EXCELLENT  
WELL MAINTAINED  
LATE MODEL  
FARM EQUIPMENT**

**Maynards**  
SINCE 1902

21700 Northwestern Hwy.  
 Suite 1180  
 Southfield, MI 48075

## AUCTION #2

**ONLINE ONLY LIVE WEBCAST (No Onsite Bidding)**

**Delta**

AG Group, LLC

WEBCAST AUCTION STARTS:

**WED., JANUARY 25<sup>TH</sup>**  
**@ 11AM CST (12PM EST)**

**LOCATION:** Mansfield, LA



**EXCELLENT WELL MAINTAINED LATE MODEL FARM EQUIPMENT**



**2014**

**23 Available**

FULL VIEW OF IRRIGATION PIVOT



**2012**

KOMATSU HB215LC-1 EXCAVATOR



**2007**

JOHN DEERE 9860STS COMBINE



**AS NEW AS  
2008**

**2 Available**

GREAT PLAINS 2700 GRAIN DRILL

### DIRECTIONS TO KINGMAN FARMS AUCTION

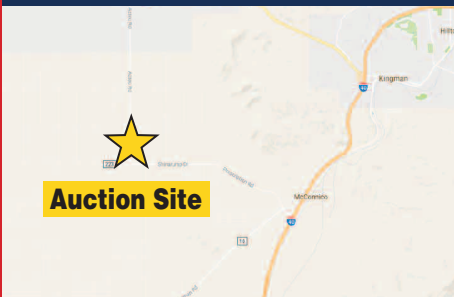

**Auction Site**

#### DIRECTIONS FROM LAUGHLIN/BULLHEAD INTERNATIONAL AIRPORT

Head northwest on Laughlin View Dr. Keep right to continue toward Laughlin Bullhead International Airport Terminal. Turn right onto Laughlin Bullhead Int Airport Terminal. Turn left onto Bullhead Pkwy. Turn right onto AZ-68E. Turn right onto Aztec Rd. Watch for Auction Signs.

### DIRECTIONS TO DELTA AG GROUP AUCTION

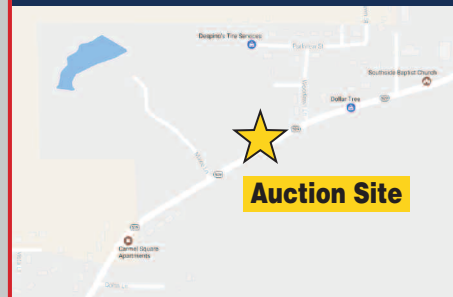

**Auction Site**

#### DIRECTIONS FROM SHREVEPORT REGIONAL AIRPORT

Head northeast toward Interstate Dr. Turn right onto Interstate Dr. Turn left to stay on Interstate Dr. Turn left toward Claude Hamel Dr. Keep right to continue on Claude Hamel Dr. Continue onto Perimeter Rd. Slight right onto Claude Hamel Dr. Turn left onto Hollywood Ave. Continue onto Meriwether Rd. Turn right onto W 70th St. Turn left to merge onto LA-3132E. Merge onto LA-3132E. Merge onto I-49S. Turn right onto LA-509. Watch for Auction Signs.

**TERMS & CONDITIONS:** All internet bidders must register for this auction at least 72-hours prior to the sale date, if you do not you will not be approved. All internet bidders must provide a wire transfer deposit of approximately 25% of your planned spending amount or \$2,500 minimum, whichever is greater in order to be approved to bid. Those who do not post the deposit will not be approved. Period. Please refer to [www.biditup.com](http://www.biditup.com) for online bidder terms. 18% Buyers Premium will Apply. Removal: Last Day of Removal February 10th (No Exceptions).

SALE CONDUCTED BY  
**Maynards**  
SINCE 1902

AUCTIONS | LIQUIDATIONS | APPRAISALS

21700 Northwestern Hwy.  
 Suite 1180  
 Southfield, MI 48075  
 Tel: (248) 569-9781

[www.maynards.com](http://www.maynards.com)

IN CONJUNCTION WITH

**BIDITUP**  
BIDITUP AUCTIONS WORLDWIDE  
 AN INDUSTRIAL ASSETS COMPANY  
[www.biditup.com](http://www.biditup.com)

Place your bid now!  
 REGISTER AT

**BidSpotter.com**